



Radiosa
Technical Information
Installation Requirements

LRE-
Rev 0
09-05-22



Radiosa Dimensions

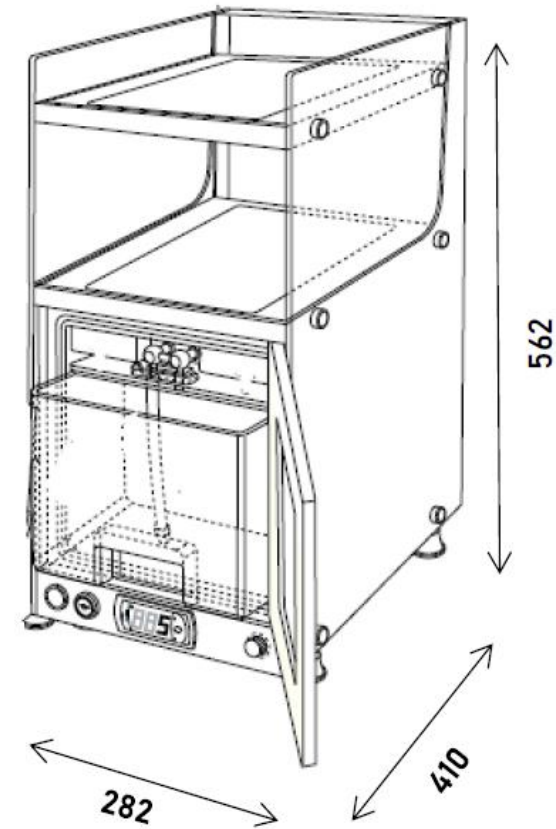
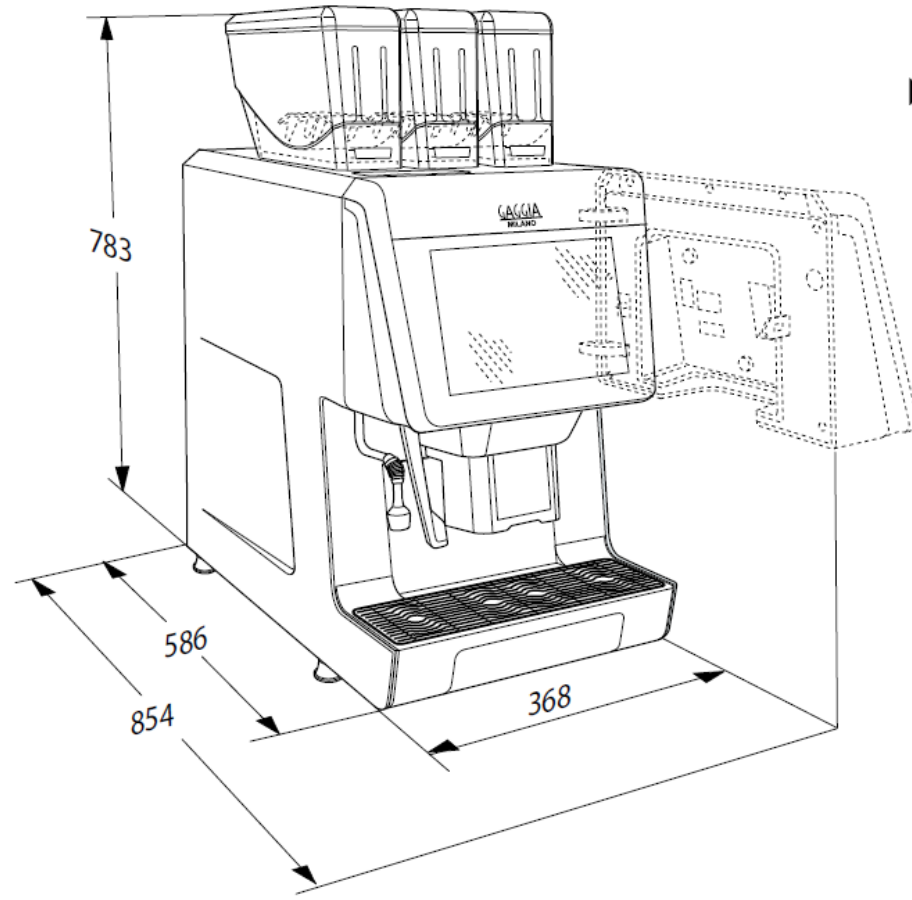

- Consideration must be taken as to daily operator actions when placing the machine on worktops above 900mm high.
- Clearances must be included to overall height and width dimensions to allow for filling and maintenance
- A minimum gap of 40mm is required for ventilation behind the machine
- The machine is only suitable for dry indoor environments and must be protected from
 - Temperatures : lower than 5°C and greater than 34°C
 - Direct Sunlight
 - Jets of water



Plumbing Fitting Requirements

All Machines are supplied and installed with:

- Anti Flood Device.
- WRAS approved hoses fitted with backflow devices to comply with Water Supply (Water fittings) Regulations 1999
- Taste and Scale Filter

15mm water supply terminating on a ¾" BSP isolation valve to be provided in advance of installation

Anti Flood Device and machine hose supplied by Lavazza Professional



30mm Clearance

Acceptable termination 15mm Isolation Valves



- Lavazza installers do not provide or make adjustments to plumbing fittings.
- Only Lavazza supplied hoses are to be used.

- Potable mains drinking water.
- Water pressure between 1.2 – 8.5 bar
- Water pressure **must** be constantly **above** 1.2 bar (see additional plumbing note)
- Termination within 1 metre of the machine
- Termination no higher than 2 meters from floor level
- Termination to be a WRAS approved ¾" BSP isolation valve
- 1x Isolation valve required for **each** machine
- No water connections directly above a power supply
- 300mm Clearance from any obstructions, (including electrical sockets)
- Isolation valve must be accessible for installation and maintenance.
- Pipe clips to extend min. 30mm from wall.
- **A** See template for service and waste cut outs
- **B** Waste water drainage is recommended and should be within 500mm of cut out
- **Electrical and plumbing must be ready and available before installation.**
- **Work top cut outs , plumbing or electrical alterations cannot be performed by the Lavazza Installer.**

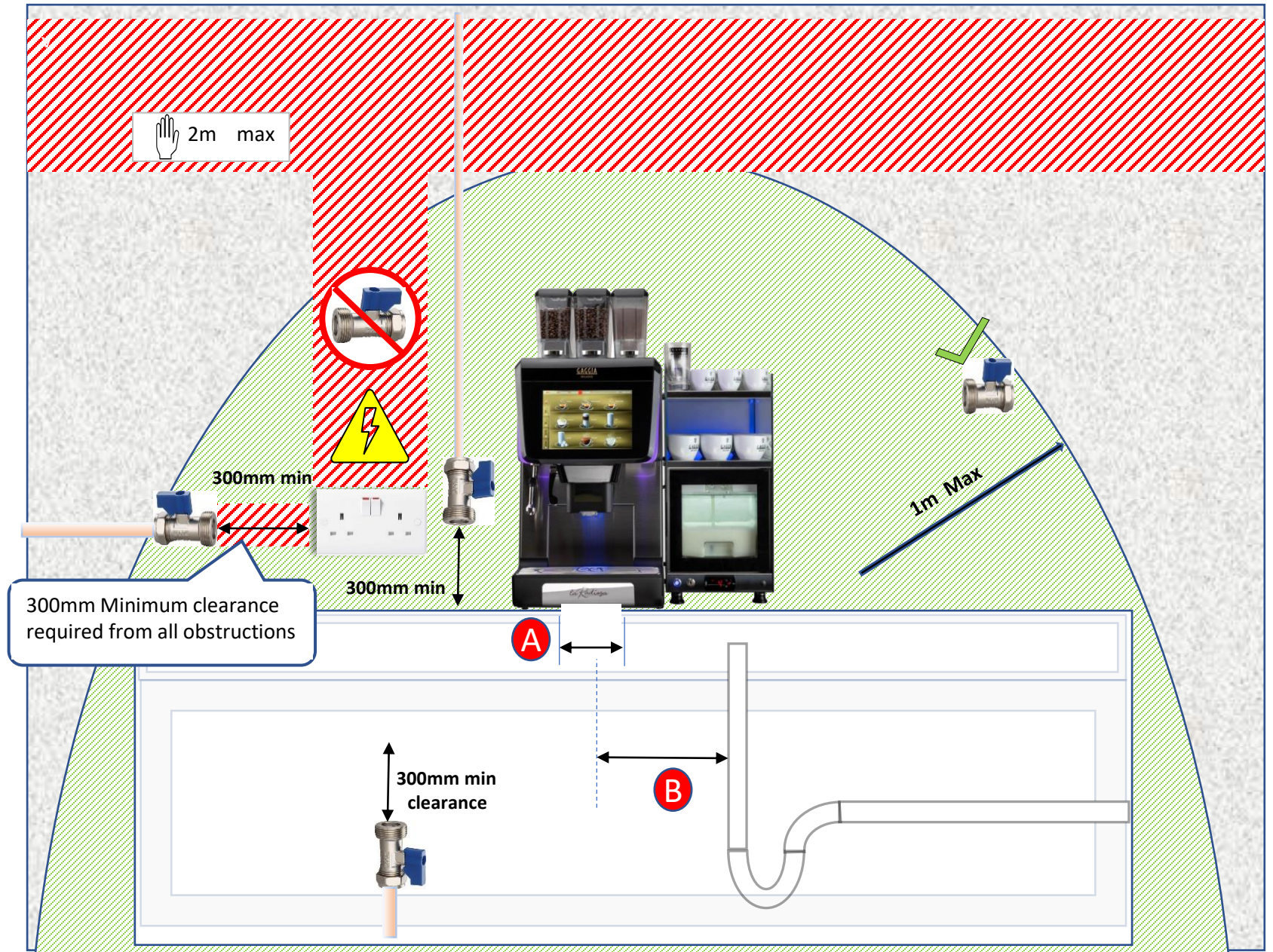



Additional Plumbing Information

- Water supply must be constantly above 1.2bar pressure. The machine performs regular automated cleansing flushes, water pressure drops below 1.2bar will be detected and disable the machine.
- Machine should only be operated with a scale filter , regular access will be required for filter maintenance
- The machine is configured for regular automatic flush sequences, external waste water drainage is recommended.
- Where waste water drainage is not practical, we recommend the use of external containers or receptacles for ease of use.
- Do not use artificially softened water supplies.



Taste and Scale Filter

DM6 Electrical Requirements

Power Specification

Voltage	230v
Frequency	50Hz
Rated Power	2750w

Connection.



The machine is fitted with a moulded 13A UK 3-pin plug



- **Electrical supply** 220/240Vac single phase terminated **within 1 metre** of the machine by a switched socket of minimum 13Amp rating.
- **Socket** should be wall mounted and be **accessible without moving the machine** or adjacent machines.
- **Extension leads** are not recommended, and if used are at the customers own liability.
- **Socket Adapters** should not be used.

Hardwiring. If hard wiring is a site requirement, this is to be performed at customers cost and a qualified electrician made available at the time of installation. Access to locking off electrical supply must be provided for maintenance.



If in doubt, seek advice from a qualified electrical installer

Counter Template



Feet position



Service Hole
Ø 100mm

- MACHINE POWER
- FRIDGE POWER
- MAINS WATER INLET
- WET WASTE (OPTIONAL)



Under counter coffee waste
Ø 100mm (OPTIONAL)

- COFFEE WASTE (IF ACCESSORY PURCHASED)

Allow 40mm gap between wall and machine for ventilation

