

TEA BREW UNIT

For models with tea brew unit only.

Whenever you load and once a week, clean the outer parts, the scraper and perform the automatic wash cycle.

SCRAPER CLEANING AND AUTOMATIC WASHING

- remove the waste conveyor

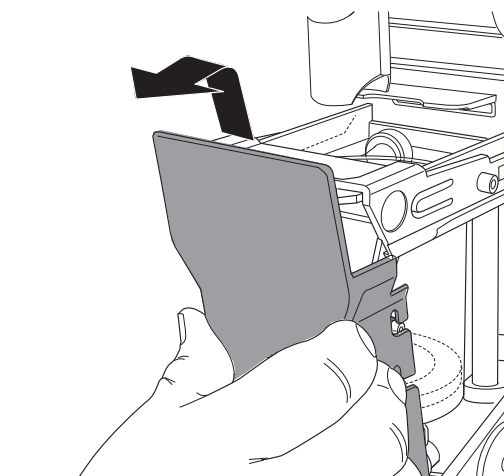

Fig. 1

- unhook the scraper from the support

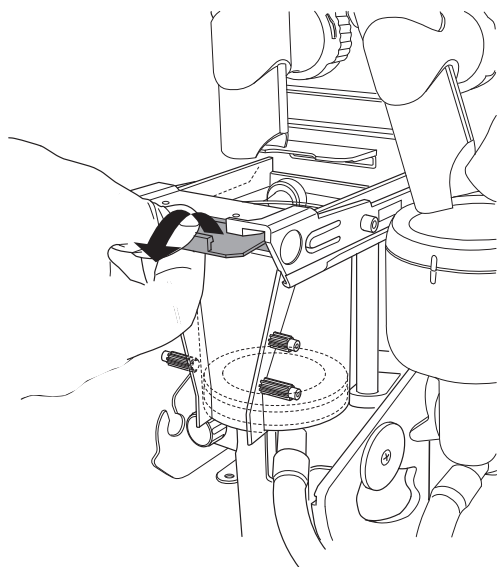

Fig. 2

- use a brush and/or a piece of clean cloth to remove the tea residues from the components and the scraper
- hook the scraper on its support
- carry out the automatic wash cycle from the programming menus

Disassemble and sanitise the components of the unit every 500 tea selections, every month or according to use conditions.

DISASSEMBLE AND CLEAN COMPONENTS:

- remove conveyor, scraper and scraper support
- detach the tube

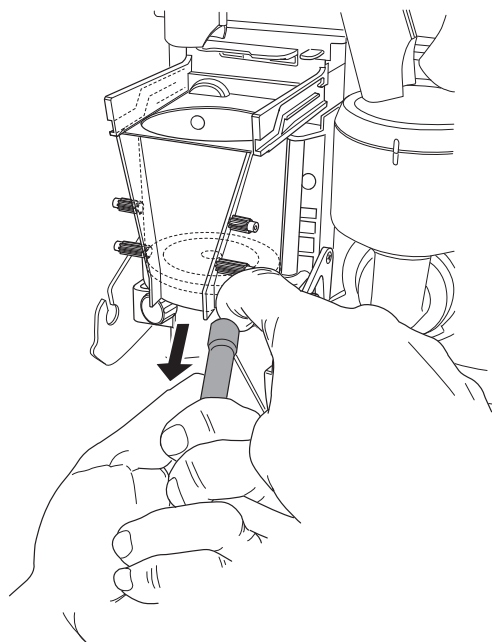

Fig. 3

- unscrew the knurl intended to secure the piston stem cover

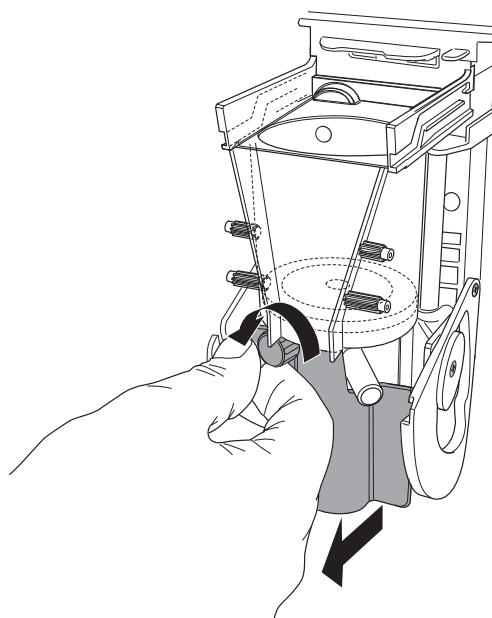

Fig. 4

- unscrew the piston stem knurl

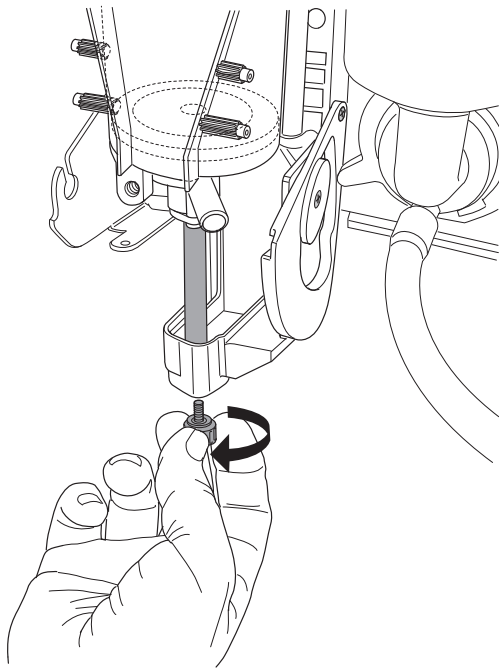

Fig. 5

- lift the piston so as to reach the top dead center

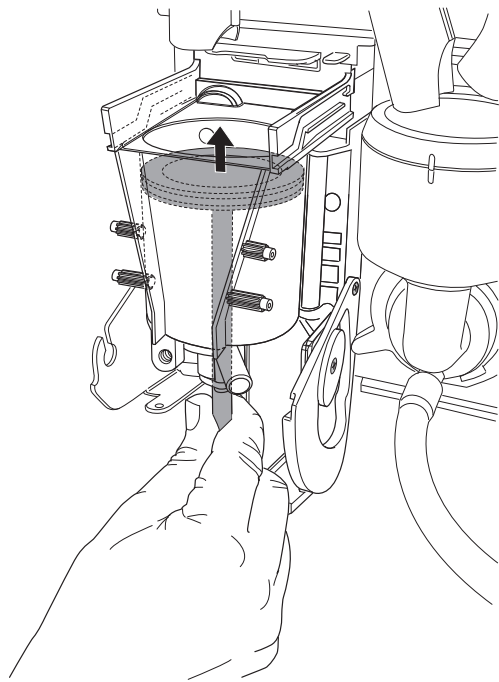

Fig. 6

- rotate the brew chamber upwards and release it

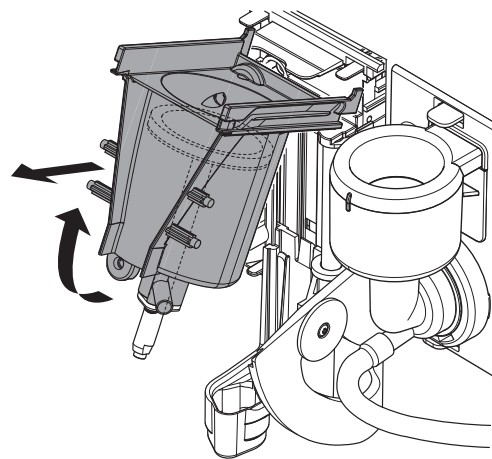

Fig. 7

- extract the piston completely

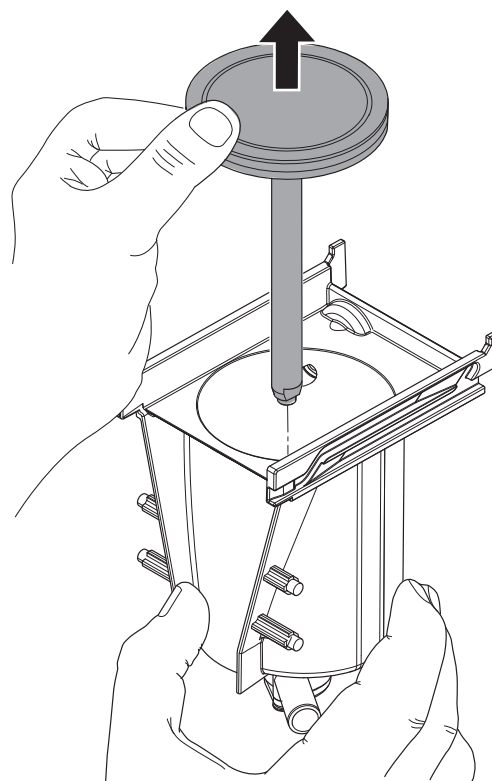

Fig. 8

After having disassembled all pieces, wash them carefully by using a detergent solution specific for tea brewers ¹and let the components immersed for one night.

To avoid leaving the equipment out of service (for too long), use components in the place of those to be sanitised (hygiene kit).

The parts replaced are to be sanitised and then made available as a hygiene kit.

After having carefully washed, rinsed and dried the parts, start assembling.

Check the state of the filter and/or gaskets; components must be any way replaced at regular intervals.

¹ Product tested N&W detergent powder/tannin remover (de-tan)

ASSEMBLY

- Re-position the piston

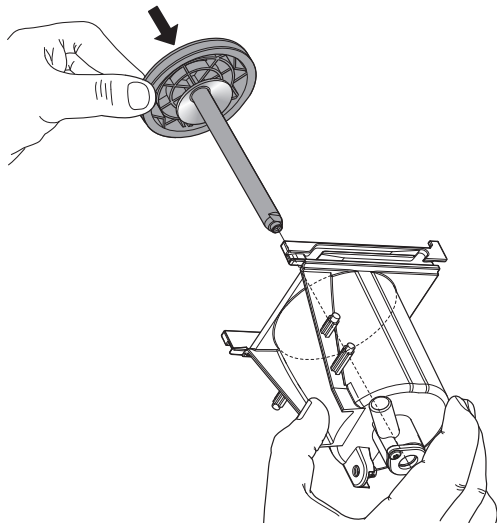

Fig. 9

- hook the brew chamber, make sure that the water coupling is properly inserted.

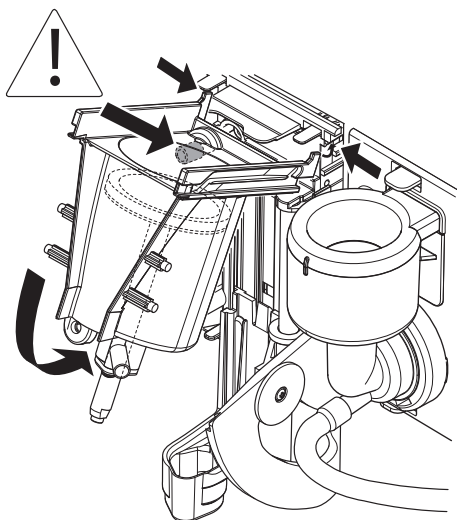

Fig. 10

- screw the piston stem knurl

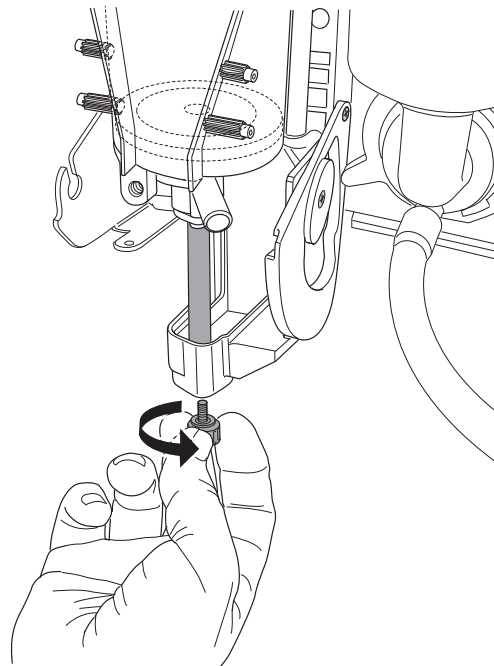

Fig. 11

- screw the piston stem cover knurl

Attention!

It is absolutely necessary to reassemble the cover before setting the machine at work once again.

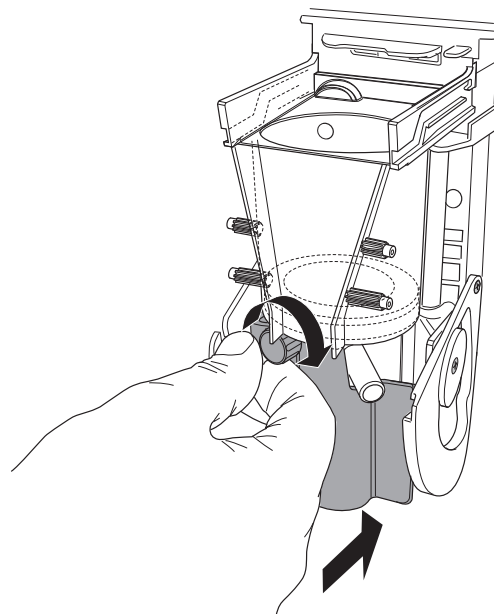

Fig. 12

- connect the tube

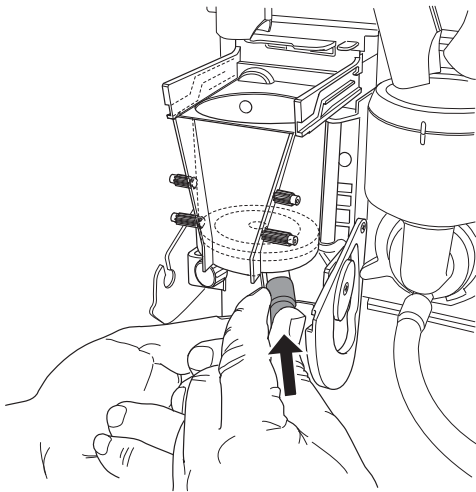

Fig. 13

- hook the scraper on its support, insert the support into the lower guides

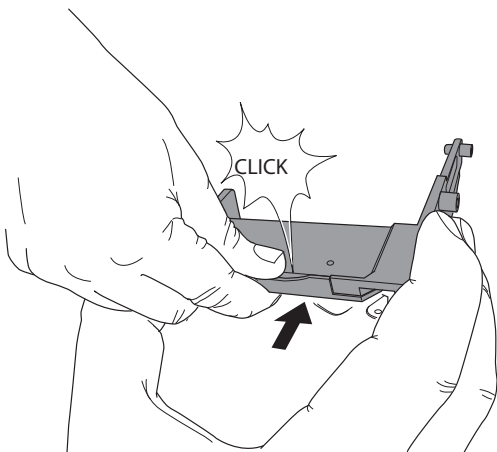

Fig. 14

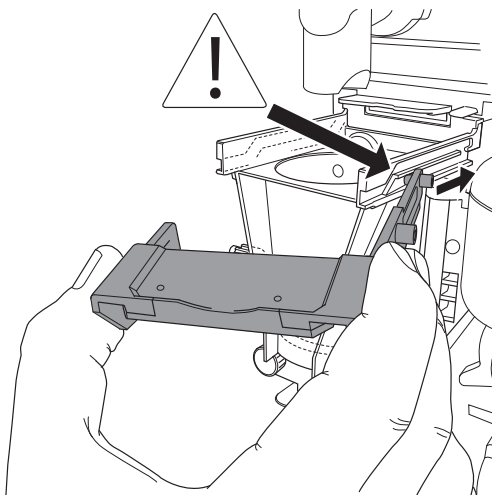

Fig. 15

- push the scraper support as far as the limit stop and put it back in its home position

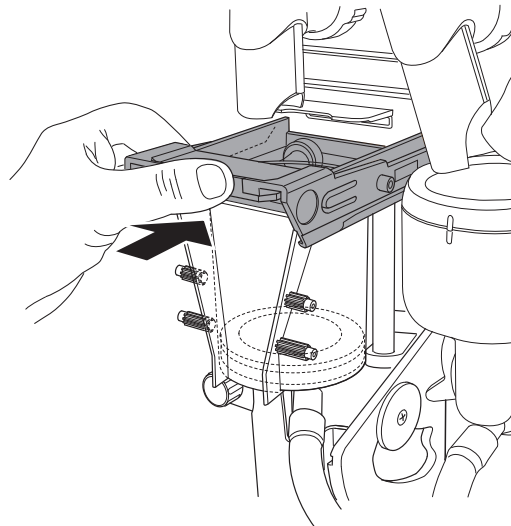

Fig. 16

- Hook the waste conveyor

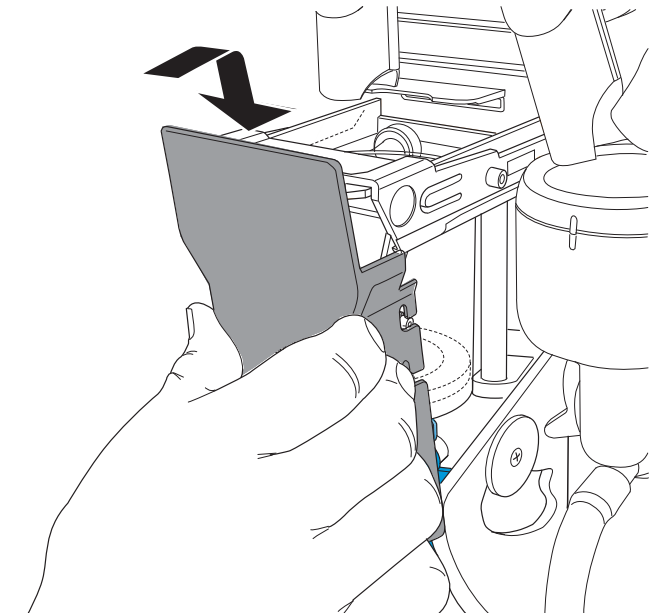

Fig. 17

- carry out the automatic wash cycle of the unit from the Technician menu > Test > Special functions

The automatic repositioning of the tea brewer guarantees the correct position for the brew cycle (Technician menu > Test > Special functions)

From the technician menu > VM configuration > wash confirm the clean cycle of the tea brewer (signal counter reset).

TEA BREWER

For models with tea brew unit only.

Whenever you power on the machine, the brew unit will re-position the unit.

DISPENSING CYCLE

- the piston is arranged in the bottom dead center while the gasket is keeping the drink outlet hole closed.
- the powder quantity is dispensed in the brew chamber
- the solenoid valve is opened and the water quantity required by the selection is dispensed
- after some seconds, the piston is lifted to let the drink flow out of the outlet hole of the brew chamber
If a larger water quantity is required by the selection, water is added during the dispensing cycle.
- the piston remains up to let the drink flow out
- the motor operates the crank, the piston is lifted as far as the top dead center, thus operating the scraper and letting used powder fall into the waste
The position of the scraper and piston is signalled by microswitches

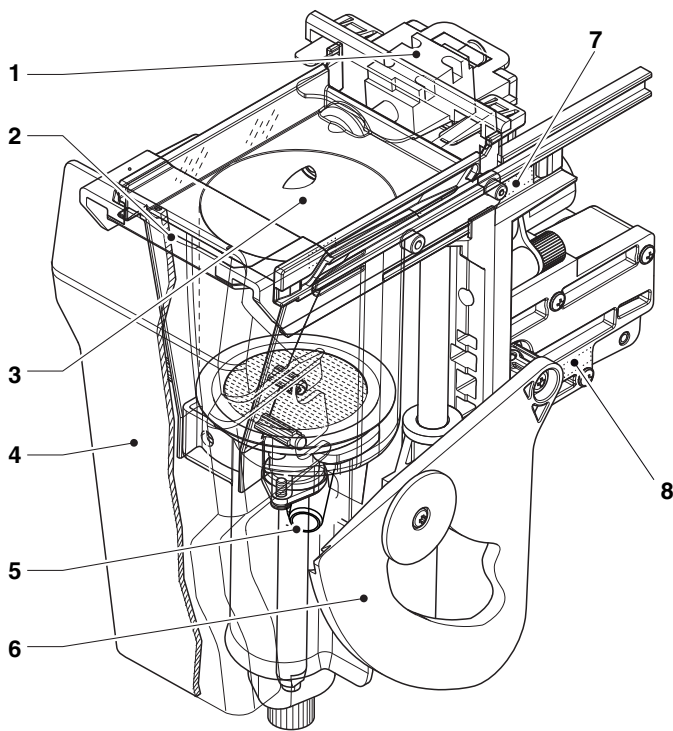

Fig. 18

- 1- Brew water solenoid valve
- 2- Scraper
- 3- Brewing chamber
- 4- Used powder chute
- 5- Tea outlet hole
- 6- Crank
- 7- Microswitch "SCRAPER POSITION"
- 8- Microswitch "PISTON POSITION"

TEA BREW UNIT

For models with tea brew unit only.

Every 6 months or 2500 tea dispensing cycles and according to the use of the machine, the water quality and the product in use, check / replace the piston filter, the gaskets and clean the powder/vapour suction conduit

DISASSEMBLY

- remove the waste conveyor

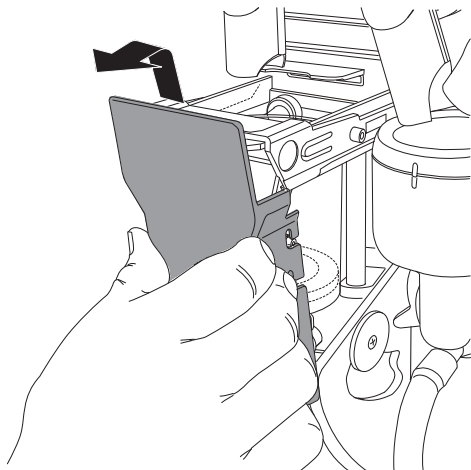

Fig. 19

- remove the scraper from the support and remove the scraper

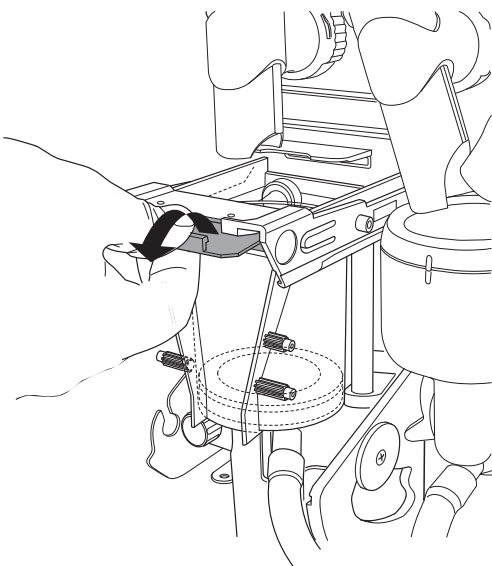

Fig. 20

- detach the tube and the relative nozzle

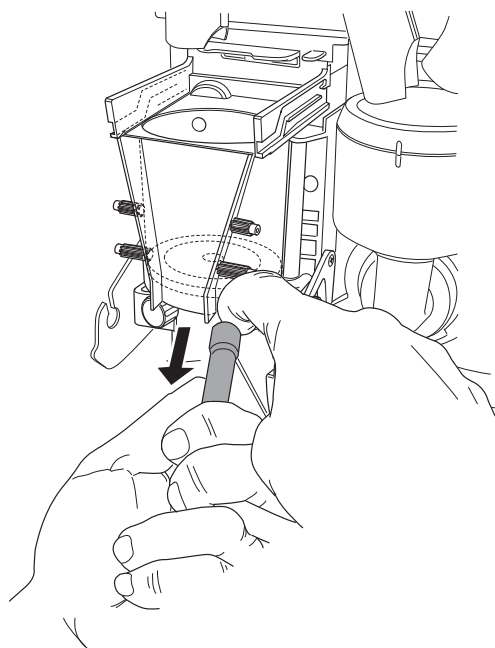

Fig. 21

- unscrew the knurl intended to secure the piston stem cover

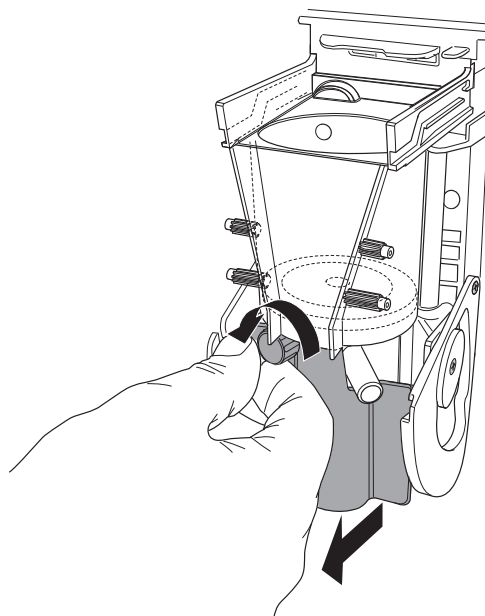

Fig. 22

- unscrew the piston stem knurl

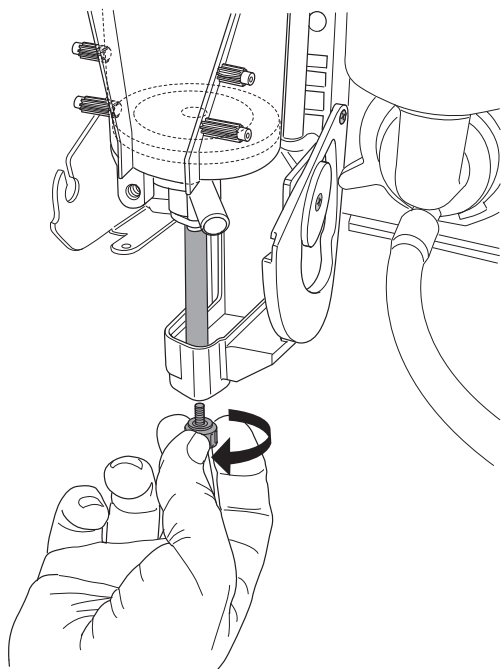

Fig. 23

- lift the piston so as to reach the top dead center

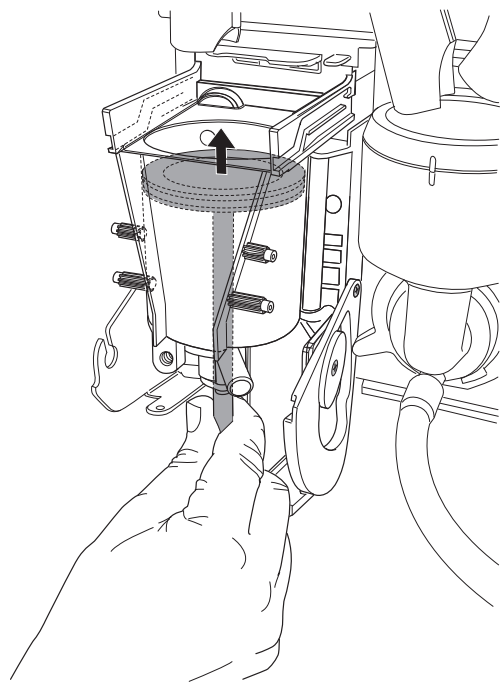

Fig. 24

- rotate the brew chamber upwards and release it

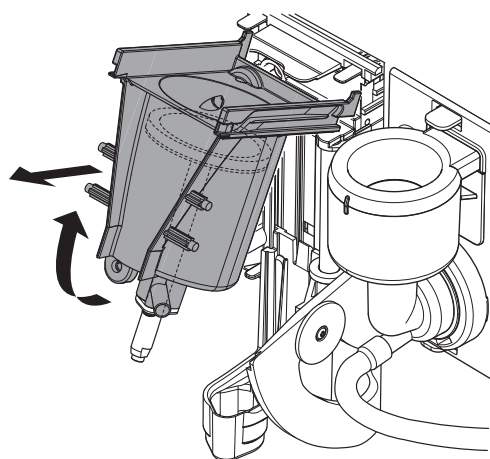

Fig. 25

- extract the piston completely and check the status of the filter and/or the gaskets.

The piston filter must be replaced every 6 months or after 2,500 dispensing cycles.

Replace the gaskets at regular intervals.

If torn and/or no longer elastic, gaskets may negatively affect the performance of the unit and the tea quality.

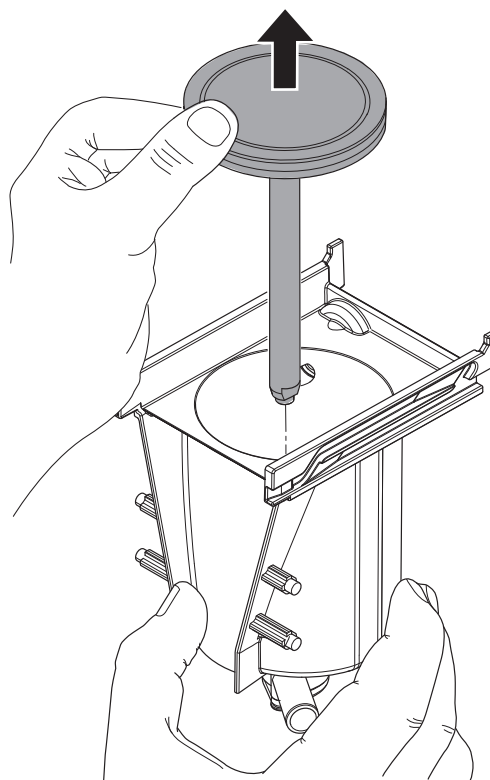

Fig. 26

The filter is secured to the stem by means of a bayonet connection.

To facilitate the removal of the filter seal ring and of the filter, use the piston retainer.

- Insert the piston retainer on the piston
- Turn the filter seal ring slightly.

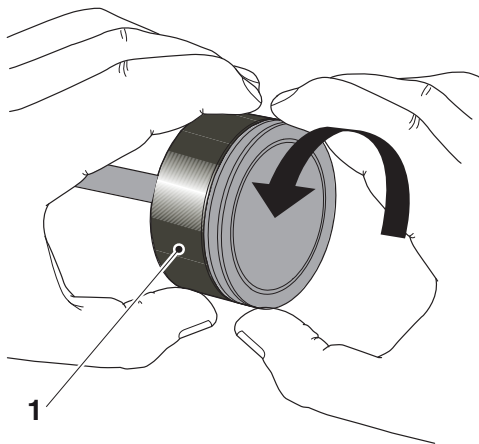

Fig. 27

1- Piston retainer

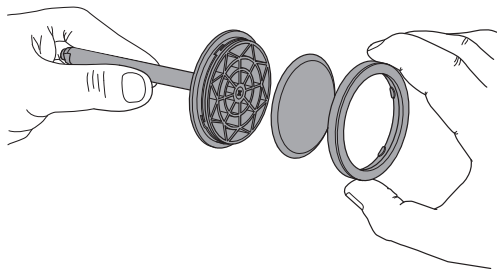

Fig. 28

Wash the components carefully by using a specific detergent solution for tea brewers².

Let the components immersed for one night.

To avoid leaving the equipment out of service (for too long), use components in the place of those to be sanitised (hygiene kit).

The parts replaced are to be sanitised and then made available as a hygiene kit.

ASSEMBLY

- re-mount the filter and the seal ring on the piston.

- re-position the piston

Pay attention while positioning: the gasket must close the drink outlet hole.

Use some fat (for food use) to grease the piston stem.

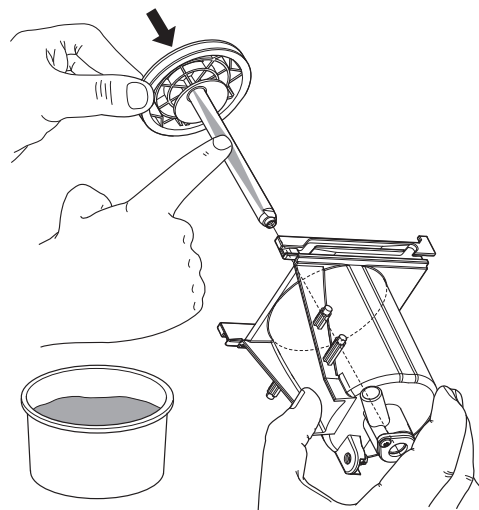

Fig. 29

- hook the brew chamber, make sure that the water coupling is properly inserted.

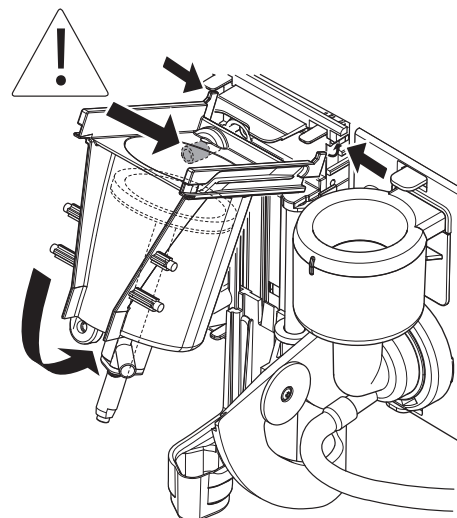

Fig. 30

- screw the piston stem knurl

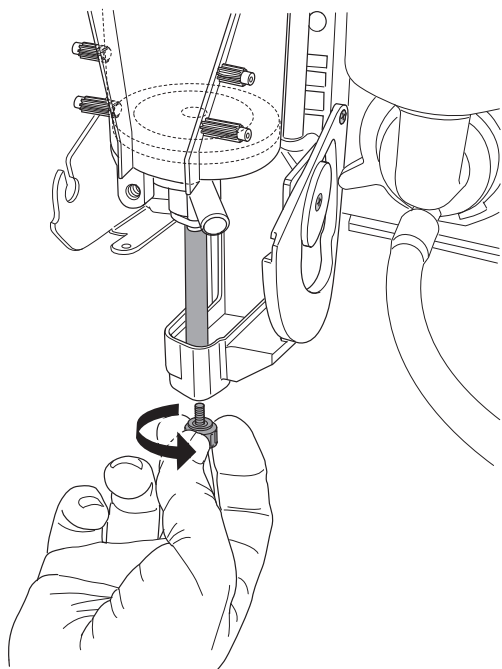

Fig. 31

- screw the piston stem cover knurl

Attention!

It is absolutely necessary to reassemble the cover before setting the machine at work once again.

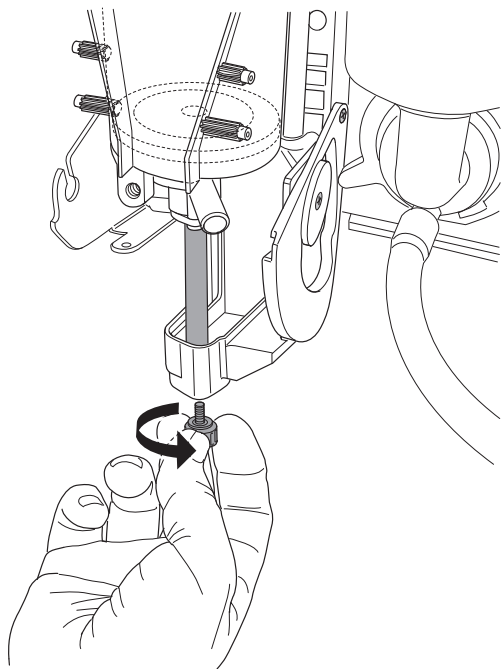

Fig. 32

- connect the tube

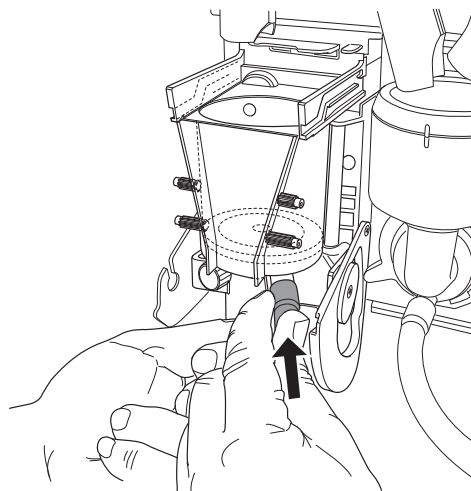

Fig. 33

- hook the scraper on its support, insert the support into the lower guides

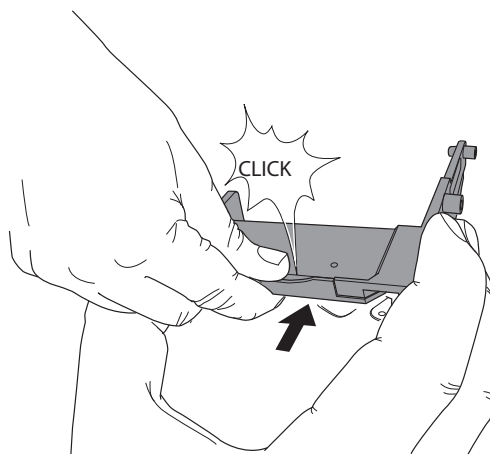

Fig. 34

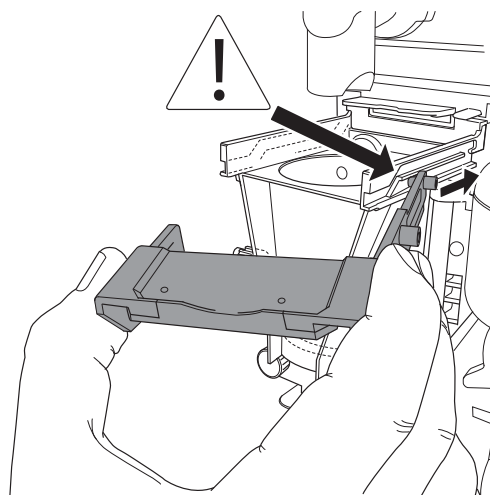

Fig. 35

- push the scraper as far as the limit stop and put it back in its home position

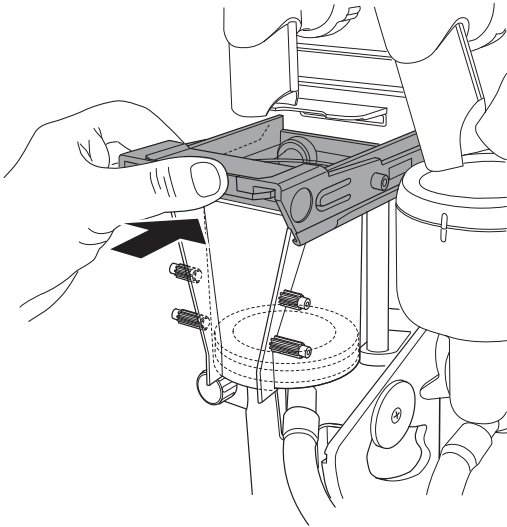

Fig. 36

- Hook the waste conveyor

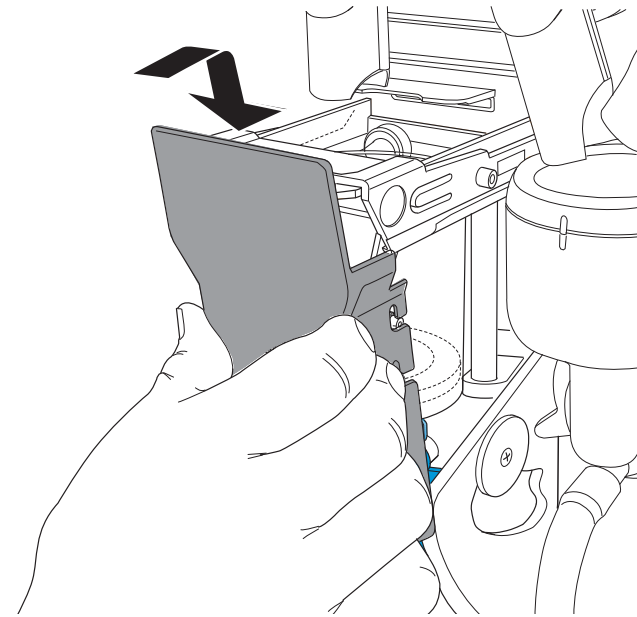

Fig. 37

- wash the unit automatically

The automatic repositioning of the tea brewer guarantees the correct position for the brew cycle (Technician menu > Test > Special functions)

From the technician menu > VM configuration> wash confirm the clean cycle of the tea brewer (signal counter reset).