

KREA PRIME IN

Below are some simple instructions for loading products and cleaning your appliance.

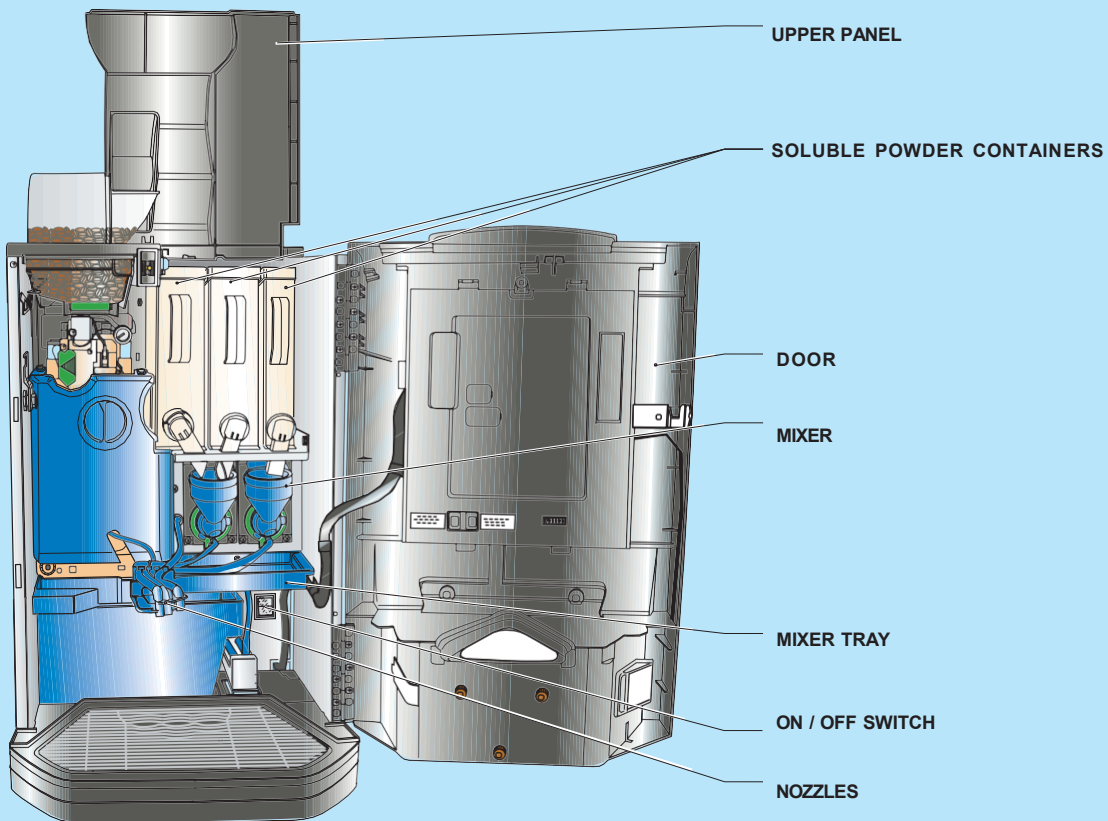

Warnings are highlighted with this symbol



PRODUCT LOADING

1

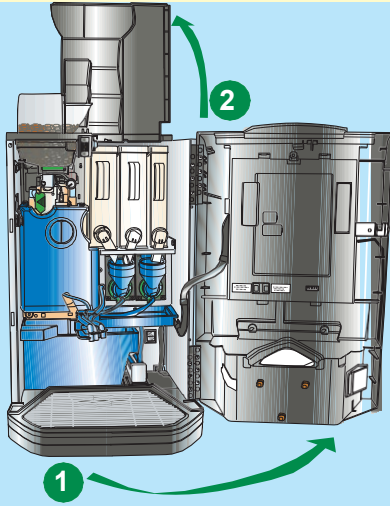

Product loading

1. Open the appliance door
2. Lift the upper panel

2

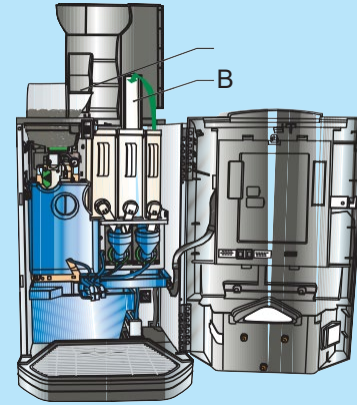

⚠ Ensure that the products to be loaded have been stored correctly and have not expired

Product loading

1. Load the soluble products into container (B), making sure that the powder is not compressed
2. If the soluble product level control is active, use the “Daily operations” function to enter the quantity of product loaded

TRAY CLEANING

1

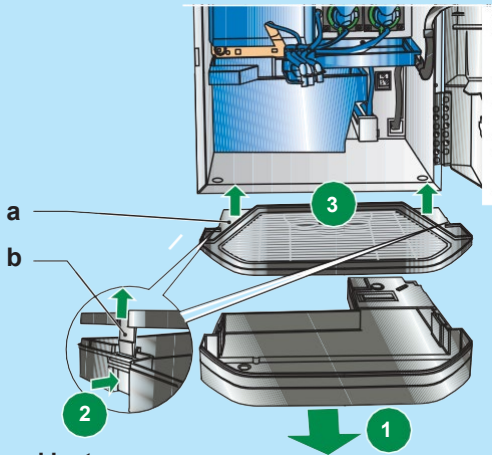

liquid residue tray

1. When the message “TRAY FULL” is displayed, open the appliance door
2. Grab the tray on its sides, lift slightly and pull
3. Press on hook B to unhook lid A of the liquid residue tray
4. Empty and wash the tray

“DAILY OPERATIONS” FUNCTION

1



1 1 1 1

1. Open the door of machine
2. Enter the programmed password (1 1 1 1)

2



1. Enter in the “daily operations” function
2. Access the desired function
 - Container filling: to indicate the quantity of product loaded
 - Residue product reset: to cancel the “residue tray full” display
 - Washing functions

Use the keys shown to scroll UP ↑ and DOWN ↓, CONFIRM ✓, CANCEL ✕

1

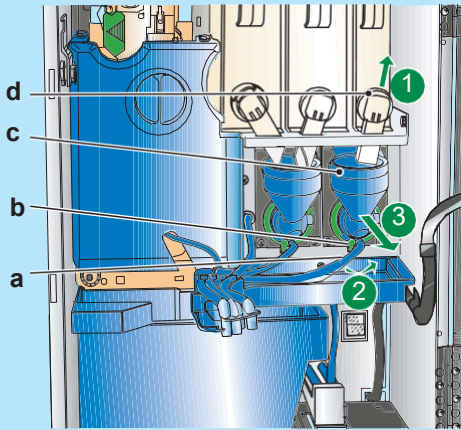

Mixer disassembly

1. Raise the soluble product conveyor (D)
2. Remove the tube (A) from the mixer
3. Turn the mixer fixing lever (B) counterclockwise
4. Remove the mixer (C)

2

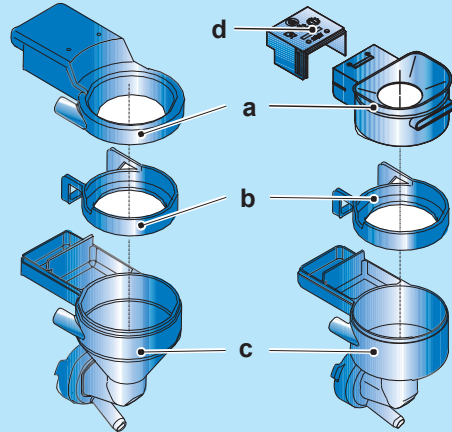

Mixer disassembly

Separate all components: funnel (A), mixer ring (B), water conveyor (C) and rear cover (D), if present

3

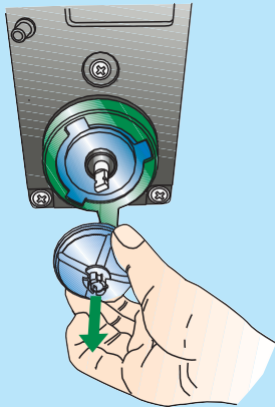

Mixer blender fan disassembly

Gently tug to remove the mixer fan

4

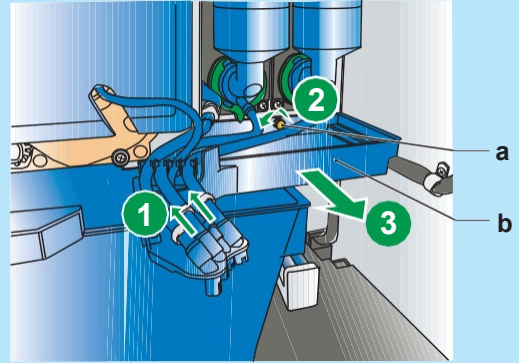

Nozzle and mixer tray disassembly

1. Remove tubes from the nozzles and separate the nozzles from the support
2. Unscrew the knurl (A) of the mixing bowl (B)
3. Remove the mixer tray

5

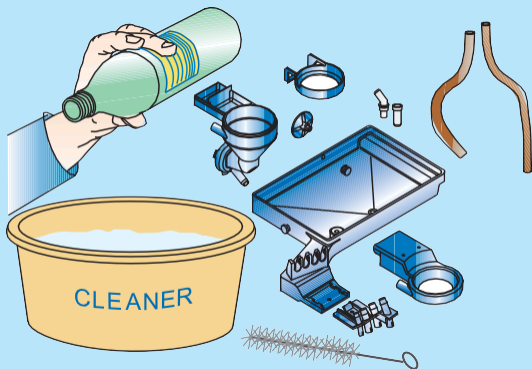

⚠ To avoid altering the taste of drinks, do not use highly scented detergents and/or solvents

Component sanitization

1. Wash all components with a sanitizing solution, making sure you remove residues and visible films using brushes and/or brushes.
2. Rinse and dry all parts thoroughly

6

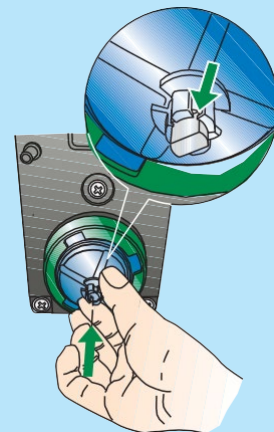

Mixer blender fan assembly

1. Reposition and push the mixer fan
2. Make sure it is inserted completely, until it clicks

7

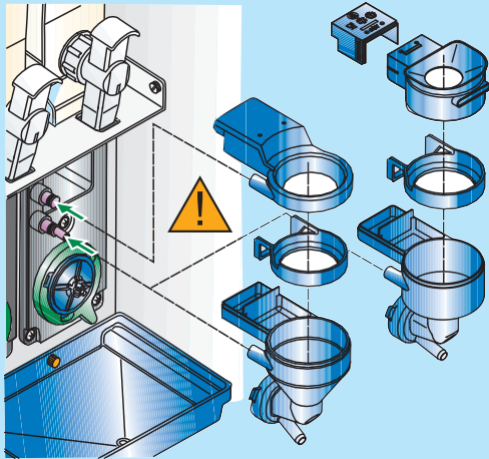

Mixer assembly

1. Reassemble the components and reposition the mixer

⚠ Make sure that the couplers are inserted correctly in the mixer

8

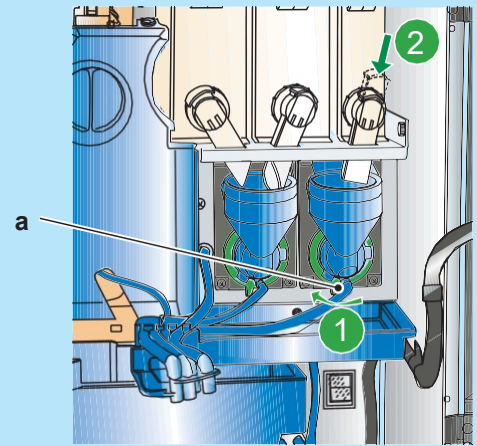

Mixer assembly

1. Turn the lever (A) clockwise to fasten the mixer to the appliance
2. Reconnect tubes to the mixers
3. Lower the soluble powder nozzles

9

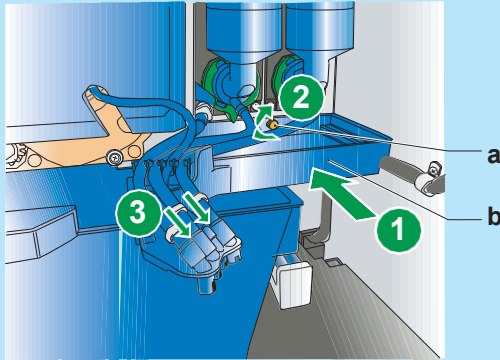

Nozzle and mixer tray assembly

1. Reposition the mixer tray (B)
2. Twist on the knurl (A)
3. Reposition the nozzles and connect their respective tubes
4. Close the door and rinse the mixer to remove any detergent residue.

10

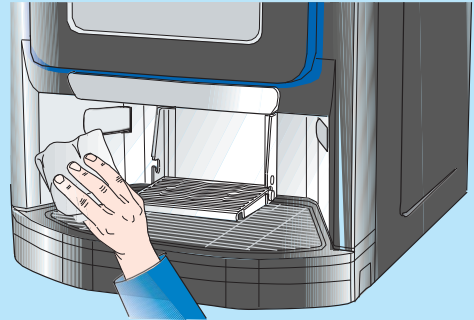

⚠ To avoid oxidation or chemical aggression risks, use neutral cleaning products (avoid using solvents).

Dispensing unit cleaning

To clean the dispensing compartment and the cup holder, use a soft cloth moistened with cleaning solution.